

CALLAHAN RESIDENCE HALL / INTERIOR REPAINTING

PROJECT SCOPE:

Northern Kentucky University Callahan Residence Hall is up for interior repainting maintenance. Scope will consist of interior repainting of main cmu corridor walls, cmu residential unit/corridor walls, adjacent hollow metal doors/frames, stairwell walls/railing system and minimal drywall patch/painting of touch up walls/ceiling areas. All areas should be cleaned, prepped per manufacturer's recommendation, and patched as necessary to accept new paint finish.

This shall include the following areas:

- All commons hallway cmu walls and adjacent doors/frames front and back unless noted otherwise on documents
- Previously painted access doors, registers, radiators and covers, exposed piping and electrical panels shall be repainted to match adjacent surfaces (i.e. color, texture and sheen), unless otherwise noted or where pre-finished. Review with project manager.
- Residential unit bedroom (estimate 221 units) cmu walls/closets, bathroom and adjacent doors/frames unless noted otherwise. Tile within bathroom excluded. Ceilings in bathrooms to be repainted. Extend of painting, refer to room schedule in drawings.
- Exclude not in scope areas as shown on the drawings.
- Exclude mechanical, electrical, custodial closets for interior wall painting unless noted otherwise.
- Exclude dining hall areas unless noted otherwise.
- Contractor responsible for moving furniture by picking up furniture to middle of rooms. NKU will put furniture back.
- Include \$5,000 allowance for drywall wall patching, sanding, and priming work. Majority of the rooms are cmu walls, but there is some wall and ceiling work.
- Base boards are existing to remain and should be cut in or equal to avoid painting over.

Drawings are for reference and scope of work. Contractor is responsible for all field verification for pricing and construction. All work must meet Local, State and Federal Codes. Contractor is responsible for securing all required permits and inspections for scope of work shown.

Project Schedule. Due to the timing of needing the units occupied for the fall semester, the following should be discussed prior to painting as a priority list of completion by July 15:

- Resident Room scope
- Resident Room Corridor Scope
- Main Floor Corridors
- Commons lounges at the end of each wing unless noted otherwise.
- Basement Level
- Alt. 1 if accepted
- Alt. 2 if accepted

VICINITY MAP

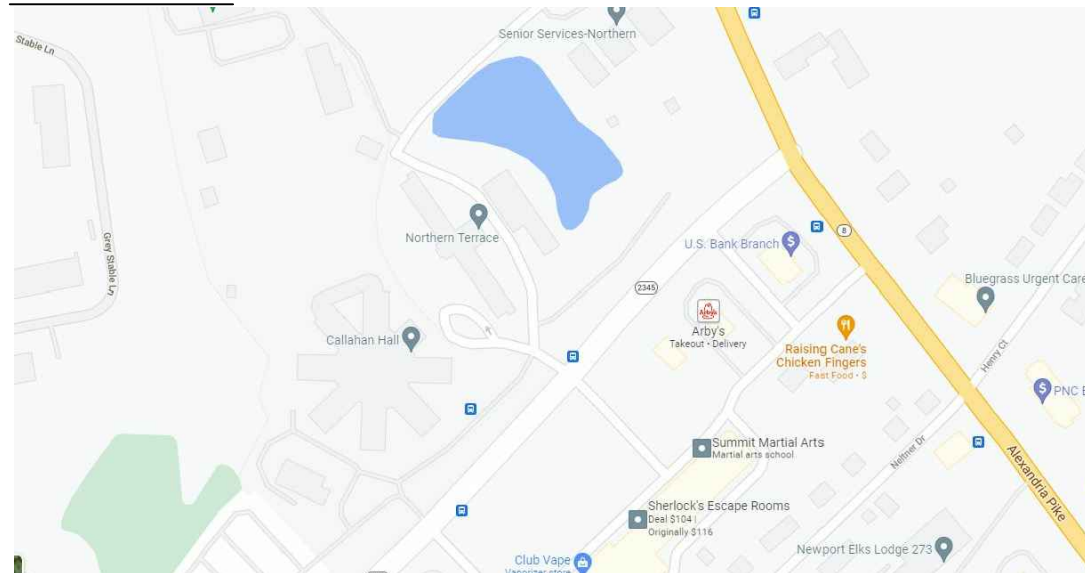

GENERAL FINISH NOTES:

1. Prepare existing wall surfaces scheduled to receive new finishes as required for specified applications and materials. Existing drywall surfaces scheduled to receive new paint will be patched, sanded or primed as required to meet Level 5 finish.
2. All metal surfaces scheduled to be painted will be prepared as required to receive a final smooth finish.
3. All finished ceiling heights 8'-0" unless noted otherwise.

FINISH LEGEND

PAINT

P-1 Sherwin Williams, NKU standard
Color: TBD
Location: General Wall Color, general corridor mechanical/closet doors/frames

P-2 Sherwin Williams, NKU standard
Color: TBD
Location: Interior resident room door/frames

P-3 : P-6 Sherwin Williams, NKU standard
Color: TBD
Location: Accent Walls

P-7 Sherwin Williams, NKU standard
Color: TBD
Location: Ceiling

P-8 Sherwin Williams, NKU standard
Color: TBD
Location: Resident Entry Room Wing Door Frames, Metal Stairwell Railings

Paint Sheen Schedule

Flat: ceilings
Flat/equal value: CMU Block Had mural Location, see drawings
Eggshell: CMU Block
Eggshell: drywall wall surfaces
Semi Gloss: wood, metal surfaces, closet hang rods, and trim

FLOORING

SC ALT Sealed concrete floor, clear.

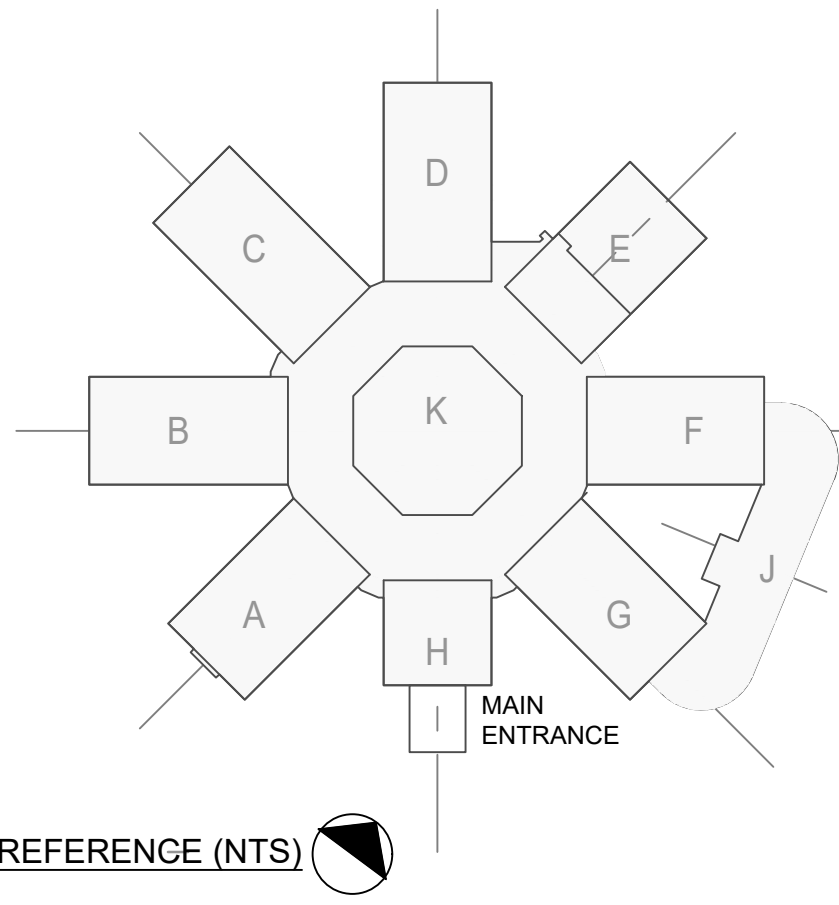

KEY PLAN REFERENCE (NTS)



Planning, Design & Construction

SHEET TITLE/PROJECT:

Callahan Residence Hall

Interior Repainting Project

Northern Kentucky University
3510 Alexandria Pike
Highland Heights, KY 41076

Cover Sheet

DATE: 01.27.2022
SCALE: 1/32" - 1'-0"
DWG STATUS:

SHEET NO.

G-0

SHEET TITLE/PROJECT:

Callahan Residence Hall

Interior Repainting Project

Northern Kentucky University
3510 Alexandria Pike
Highland Heights, KY 41076

Basement Level

DATE: 01.27.2022

SCALE: 1/32" = 1'-0"

DWG STATUS:

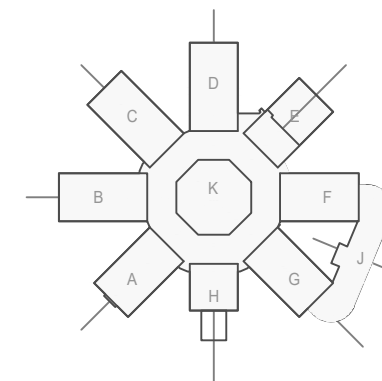

SHEET NO.

A-0

SHEET KEY NOTES

1. All walls Paint P-1 unless noted otherwise.
2. All residential unit bedroom walls/closets Paint P-1 unless note otherwise. Adjacent doors/frames P-8. Tile walls within bathroom excluded. Paint bathroom ceiling P-7.
3. Paint Accent Color P-tbd.
4. Alternate 1: Stairwell cmu walls to be repainted along with all handrail systems. If accepted, all stairwell painting work to follow phasing of removal of asbestos flooring. Wall Color Selection TBD, railings P-8.
5. Alternate 2: remove existing concrete floor painted coating; grind as needed to provide smooth surface to receive clear sealant

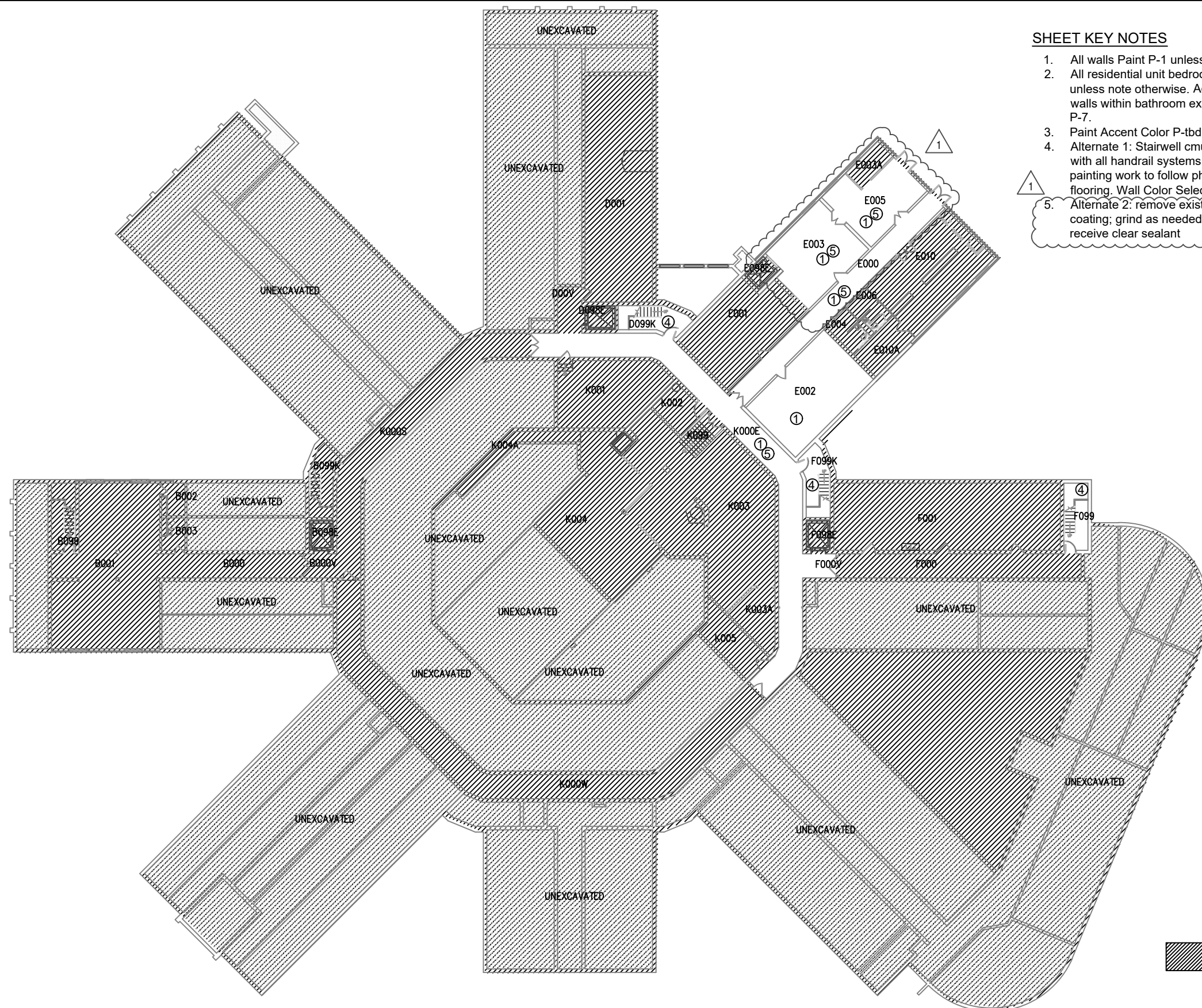

Planning, Design & Construction

SHEET TITLE/PROJECT:

Callahan Residence Hall

Interior Repainting Project

Northern Kentucky University
3510 Alexandria Pike
Highland Heights, KY 41076

First Floor

DATE: 01.27.2022

SCALE: 1/32" = 1'-0"

DWG STATUS:

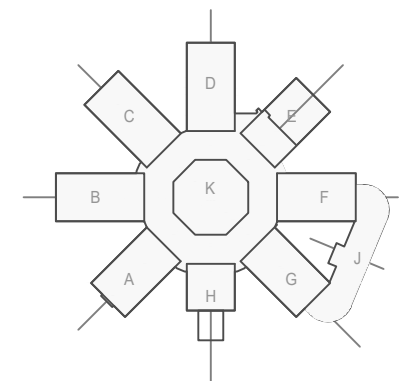

SHEET NO.

A-1

- SHEET KEY NOTES**
- All walls Paint P-1 unless noted otherwise. Main corridor trades closet doors/frames to receive P-1. Resident wing/entry room doors P-1/door frame P-8.
 - Residential unit bedroom walls/closets Paint P-1 unless noted otherwise. Interior doors/frames P-2. Tile walls within bathroom excluded. Paint bathroom ceiling P-7. Closet hang rods paint P-8 unless metal.
 - Paint Accent Color P-tbd.
 - Alternate 1: Stairwell cmu walls to be repainted along with all handrail systems. If accepted, all stairwell painting work to follow phasing of removal of asbestos flooring. Wall Color Selection TBD, railings P-8.
 - Bold Paint Location. Will need additional paint/primer for consistent new finish.
 - Bold Paint Location. Paint to Match. This area to be completed last in schedule.
 - Mural Location: paint as needed in flat or equivalent to prep wall for new paint in order for mural to not show through. See photos for reference.
 - Solarium area to be used for furniture storage during work; not necessary to complete by July 15. Review schedule and color scheme with owner.

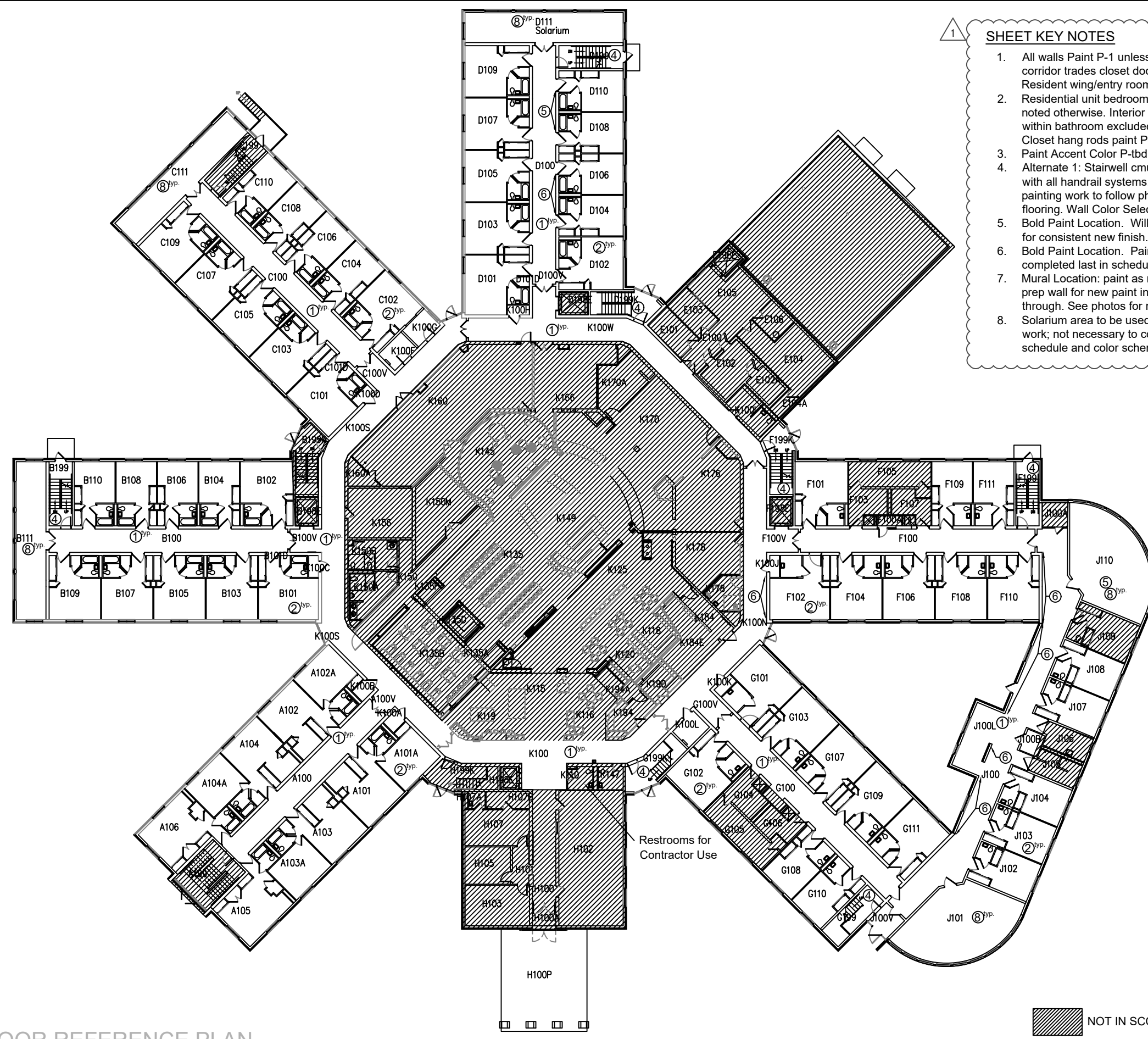

FIRST FLOOR REFERENCE PLAN

SCALE: 1/32" = 1'-0"

Planning, Design & Construction

SHEET TITLE/PROJECT:

Callahan Residence Hall

Interior Repainting Project

Northern Kentucky University
3510 Alexandria Pike
Highland Heights, KY 41076

Second Floor

DATE: 01.27.2022

SCALE: 1/32" = 1'-0"

DWG STATUS:

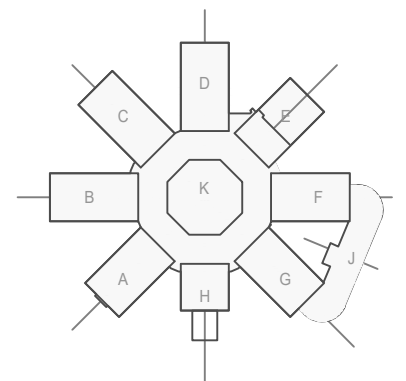

SHEET NO.

A-2

- SHEET KEY NOTES**
- All walls Paint P-1 unless noted otherwise. Main corridor trades closet doors/frames to receive P-1. Resident wing/entry room doors P-1/door frame P-8.
 - Residential unit bedroom walls/closets Paint P-1 unless noted otherwise. Interior doors/frames P-2. Tile walls within bathroom excluded. Paint bathroom ceiling P-7. Closet hang rods paint P-8 unless metal.
 - Paint Accent Color P-tbd.
 - Alternate 1: Stairwell cmu walls to be repainted along with all handrail systems. If accepted, all stairwell painting work to follow phasing of removal of asbestos flooring. Wall Color Selection TBD, railings P-8.
 - Bold Paint Location.** Will need additional paint/primer for consistent new finish.
 - Bold Paint Location.** Paint to Match. This area to be completed last in schedule.
 - Mural Location:** paint as needed in flat or equivalent to prep wall for new paint in order for mural to not show through. See photos for reference.
 - Solarium area to be used for furniture storage during work; not necessary to complete by July 15. Review schedule and color scheme with owner.



SECOND FLOOR REFERENCE PLAN

SCALE: 1/32" = 1'-0"

Planning, Design & Construction

SHEET TITLE/PROJECT:

Callahan Residence Hall

Interior Repainting Project

Northern Kentucky University
3510 Alexandria Pike
Highland Heights, KY 41076

Third Floor

DATE: 01.27.2022

SCALE: 1/32" = 1'-0"

DWG STATUS:

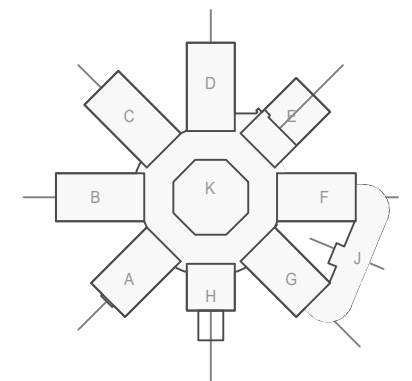

SHEET NO.

A-3

SHEET KEY NOTES

1. All walls Paint P-1 unless noted otherwise. Main corridor trades closet doors/frames to receive P-1. Resident wing/entry room doors P-1/door frame P-8.
2. Residential unit bedroom walls/closets Paint P-1 unless noted otherwise. Interior doors/frames P-2. Tile walls within bathroom excluded. Paint bathroom ceiling P-7. Closet hang rods paint P-8 unless metal.
3. Paint Accent Color P-tbd.
4. Alternate 1: Stairwell cmu walls to be repainted along with all handrail systems. If accepted, all stairwell painting work to follow phasing of removal of asbestos flooring. Wall Color Selection TBD, railings P-8.
5. Bold Paint Location. Will need additional paint/primer for consistent new finish.
6. Bold Paint Location. Paint to Match. This area to be completed last in schedule.
7. Mural Location: paint as needed in flat or equivalent to prep wall for new paint in order for mural to not show through. See photos for reference.
8. Solarium area to be used for furniture storage during work; not necessary to complete by July 15. Review schedule and color scheme with owner.

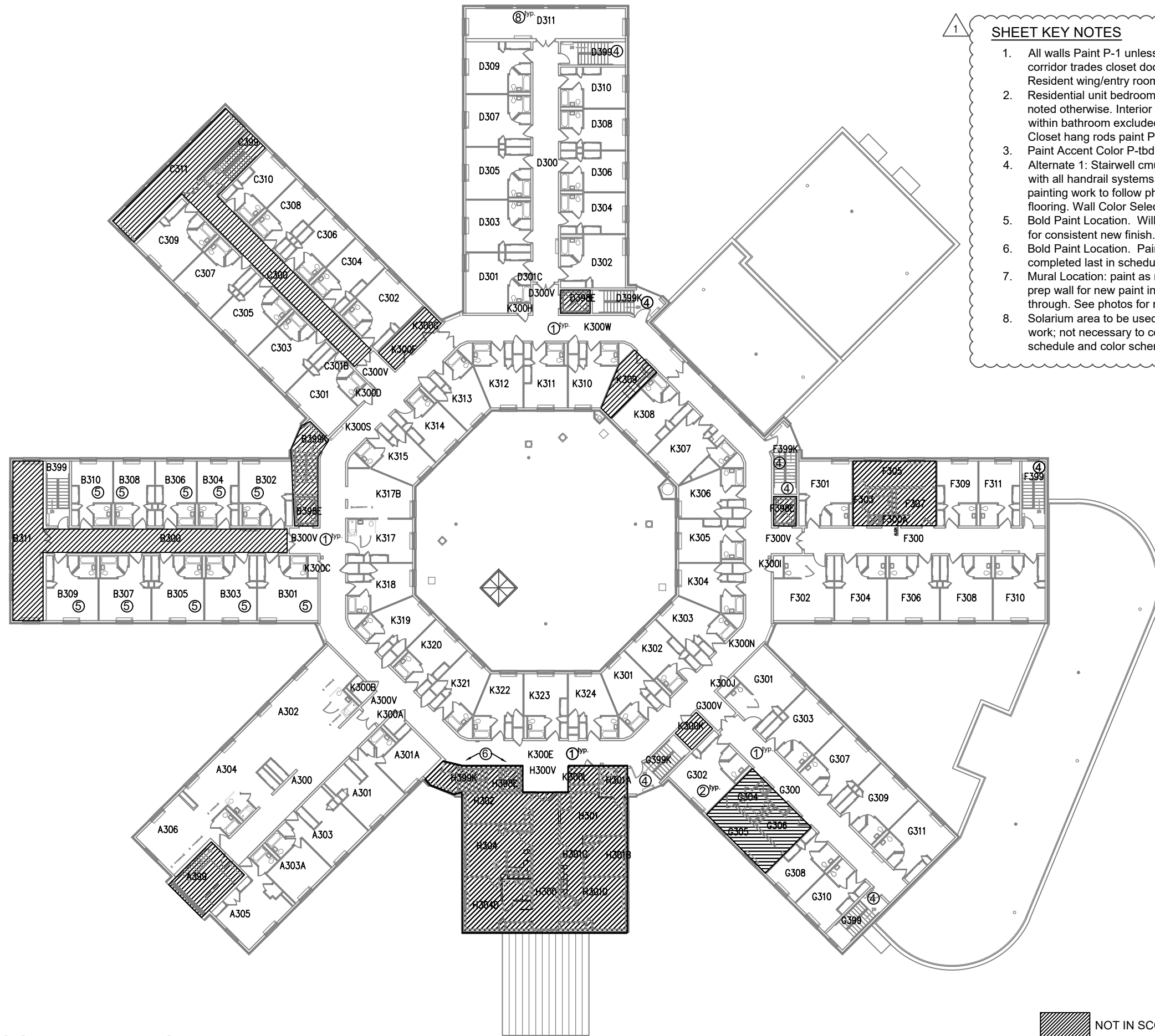

THIRD FLOOR REFERENCE PLAN

SCALE: 1/32" = 1'-0"



First Floor J Wing Wall Mural



Typical Residential Wing Corridor

**Planning, Design &
 Construction**

SHEET TITLE/PROJECT:

**Callahan
 Residence
 Hall**

Interior Repainting Project

Northern Kentucky University
 3510 Alexandria Pike
 Highland Heights, KY 41076

Reference Photos

DATE: 01.27.2022
 SCALE: 1/32" = 1'-0"
 DWG STATUS:

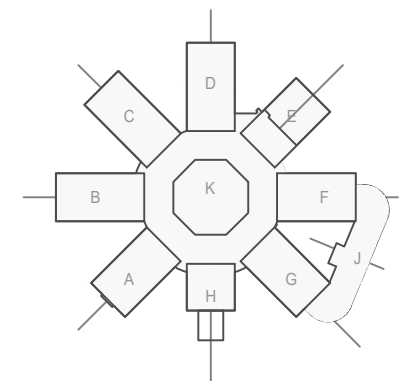

SHEET NO.

A-4